

AGO\_2020\_REV\_00

## ROOM THERMOSTAT WITH CABLE

R x0203 is used to control the room temperature by setting the desired target temperature for actuator control in heating or heating / cooling (HK) mode.

The manufacturer is not responsible for any other use deemed inappropriate.

Operation with the 24 V controller is only permitted with a safety transformer according to EN 61558-2-6.



- The electrical installation must be carried out in a stress-free state in accordance with the national regulations in force and requirements of the local electrical supply company, by an authorized specialist.
- The device can only be opened by an authorized expert, and only when the device is in good, stress-free condition.
- Use the device only when it is in perfect working order.
- Make sure that no children play with this product. If necessary, children must be supervised.

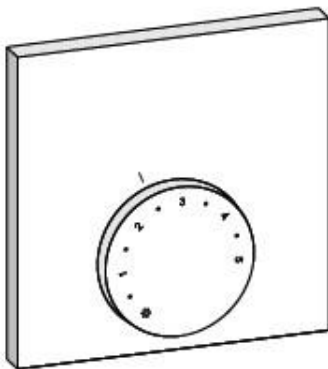

R 40203-10 - 24 V  
R 40203-40 - 24 V, HK  
R 20203-10 - 230 V  
R 20203-40 - 230 V, HK



**MOUNTING POSITION:**

External heat sources can affect the function of the regulator.

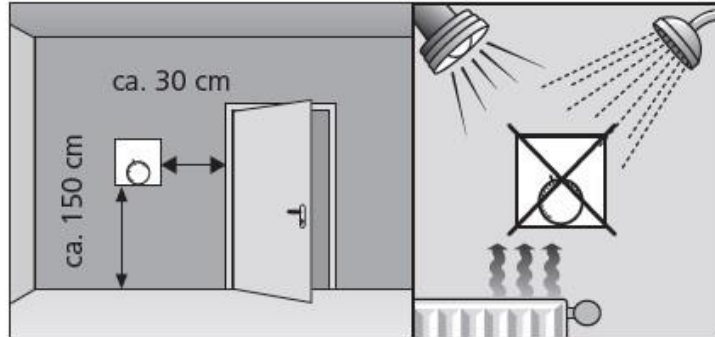

**MOUNTING:**

The regulator mounts directly to the wall or in a baseboard under plaster. Create the electrical connection as shown in Figure 3a or 3b.

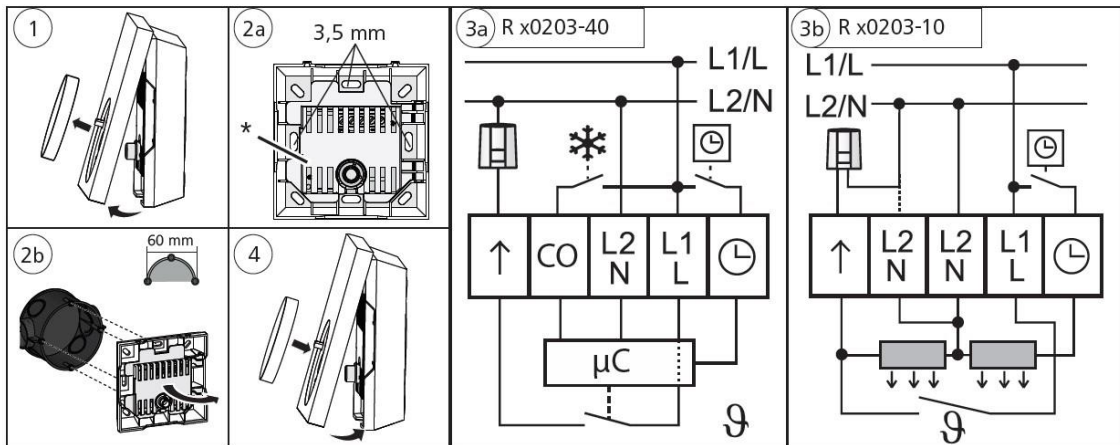

\*protective cover

**Only R 40203-40 and R 20203-40**

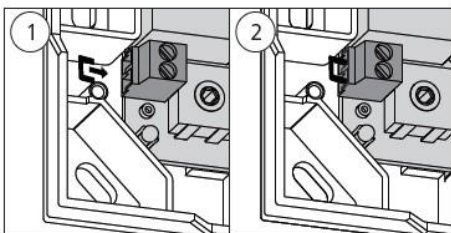

The controller can be used in heating systems. and cooling To turn off the cooling function, turn off the with electricity, and interconnect through touch the contacts on the bottom left.

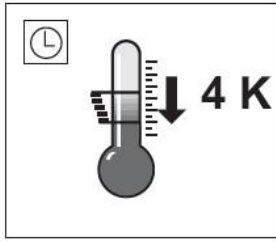
**REDUCTION TEMPERATURE:**

The 4 K reduction temperature can be activated by L / L1 a, for example, by an external switch.

**ELIMINATION:**

1. Turn off the power supply.
2. Disconnect the cables.
3. Remove the regulator and, if necessary, dispose of properly as waste.

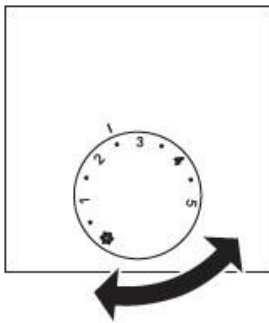
**TARGET TEMPERATURE:**

The target temperature is set by turning the setpoint generator.

**CALIBRATION OF THE REFERENCE VALUE:**

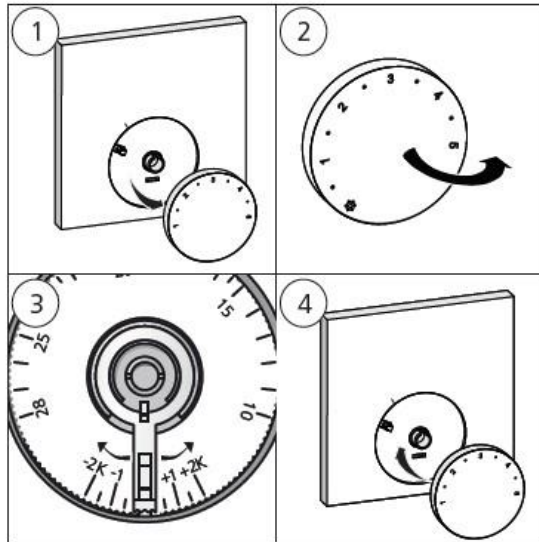

1. Decrease the reference value generator.
2. Make sure to calibrate the reference value or compared to the ambient temperature is possible, between -2 K ... + 2 K.

**Optional:**

Narrow the temperature range. Use the min. and max. to adjust the temperature.

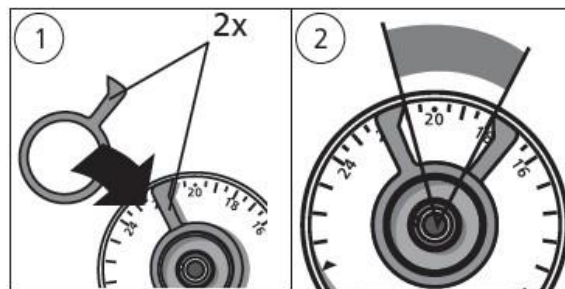

**TECHNICAL FEATURES:**

<b>Operating Voltage</b>	_____	24 V ± 20%, 50Hz
	_____	230V ± 10%, 50 Hz
<b>Security v24 V / 230 V</b>	_____	T1A / T2AH
<b>Switch Element 24 V / 230V</b>	_____	Triac / Relé
<b>Switching capacity 24 V / 230 V</b>	_____	1 A resistive load
	_____	2 A resistive load
<b>Rated current without actuator units</b>	_____	24 V: ≤20 mA
	_____	230 V: ≤2 mA
<b>Maximum allowed current consumption of connected actuators: 24 V</b>	_____	1 A / 230 V: 1.8 A
<b>Temperature setting range</b>	_____	10 °C - 28 °C
<b>Reference value calibration</b>	_____	± 2 K
<b>Reduction temperature</b>	_____	4 K
<b>Temperature sensor range</b>	_____	0 - 40 °C
<b>Measurement precision</b>	_____	± 0,5 K
<b>Room temperature</b>	_____	0 - 50 °C
<b>Storage temperature range</b>	_____	-25 a +75 °C

Permitted. ambient humidity \_\_\_\_\_ 80% without condensation  
Temperature. Ball Pressure Test: Terminal \_\_\_\_\_ 100 ° C  
\_\_\_\_\_ Material housing  
\_\_\_\_\_ plastic: 75 ° C  
Accordance CE \_\_\_\_\_ EN 60730  
Protection class 24 V / 230 V \_\_\_\_\_ III / II  
Degree of protection \_\_\_\_\_ IP 20  
Nominal pulse voltage \_\_\_\_\_ 1500 V  
Pollution Degree \_\_\_\_\_ 2  
Operating mode \_\_\_\_\_ Typ 1 / Typ 1.C  
Weight \_\_\_\_\_ 90  
g  
Dimensions (width xyx a) \_\_\_\_\_ 86 x 86 x 29 mm  
Frost protection function \_\_\_\_\_ From +6 ° C in heating mode.  
Idle in cooling mode.

**Only controllers with heating and cooling function:**

Valve protection function: every 14 days for 6 minutes after the last activation.